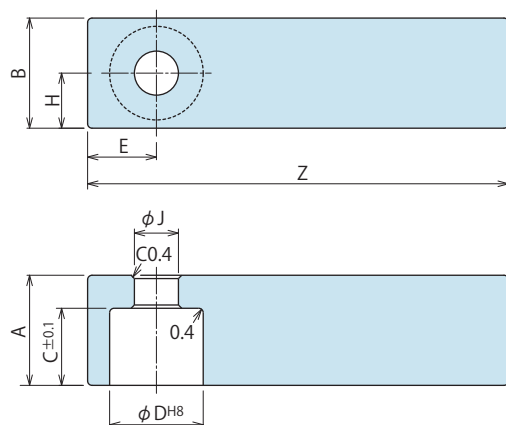

Accessory : Material Swing Lever for Taper Lock Option

(mm)

Model No. Indication

WHZ 040 0 - TSize
(Refer to the table.)Design No.
(Revision Number)

Model No.	WHZ0320-T	WHZ0400-T	WHZ0500-T	WHZ0630-T
Corresponding Model No.	WHA0320-2□□ WHA0320-2□□D WHA0320-2□□-Q25	WHA0400-2□□ WHA0400-2□□D WHA0400-2□□-Q25	WHA0500-2□□ WHA0500-2□□D WHA0500-2□□-Q25	WHA0630-2□□ WHA0630-2□□D WHA0630-2□□-Q25
A	20	22	28	35
B	20	22	28	35
C	14	18	22	24
D	17 ^{+0.027} ₀	19 ^{+0.033} ₀	24 ^{+0.033} ₀	29 ^{+0.033} ₀
E	12.5	13	16	19
H	10	11	14	17.5
J	9	9	11	14
Z	90	125	150	180

Notes :

- Material : S45C Surface Finishing : Alkaline Blackening
- If necessary, the front end should be additionally machined and finished.
- When determining the phase, refer to taper lock lever design dimensions for each model for the additional machining.

※1. Refer to Accessory of Quick Change Lever Option A for -A (Quick Change Lever Option A). Refer to Accessory of Quick Change Lever Option F for -F (Quick Change Lever Option F). For -P (Balance Lever Option), it should be designed by customer.

Accessory : Material Swing Lever for Quick Change Lever Option A

(mm)

Model No. Indication

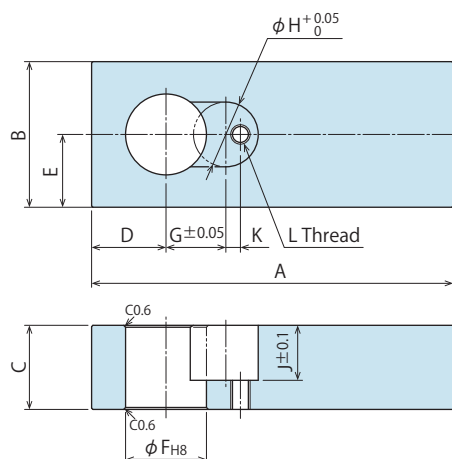
WHZ 160 0 - ASize
(Refer to the table.)Design No.
(Revision Number)

Model No.	WHZ1000-A	WHZ1600-A	WHZ2500-A	WHZ4000-A
Corresponding Model No.	WHA0320-2□□□-A	WHA0400-2□□□-A	WHA0500-2□□□-A	WHA0630-2□□□-A
A	90	125	150	170
B	25	28	34	45
C	16	18	22	26
D	12.5	14	17	23
E	12.5	14	17	22.5
F	14 ^{+0.027} ₀	16 ^{+0.027} ₀	20 ^{+0.033} ₀	25 ^{+0.033} ₀
G	12	13	16	18.5
H	12	12	15	20
J	11	11	13	17
K	2	2	2.5	4.5
L	M4×0.7	M4×0.7	M5×0.8	M6×1

Notes :

- Material : S50CH Surface Finishing : Alkaline Blackening
- If necessary, the front end should be additionally machined and finished.
- The pin hole for stopper and lever phasing should be additionally machined by referring to Quick Change Lever Option A Design Dimensions.
- Tightening Kit (WHZ□-W) for Quick Change Lever Option A is sold separately.

Accessory : Tightening Kit for Quick Change Lever Option A

Model No. Indication

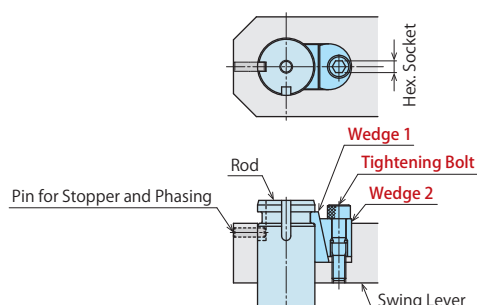
WHZ 160 1 - WSize
(Refer to the table.)Design No.
(Revision Number)

Tightening Kit for mounting Quick Change Lever Option A.
Sold separately from clamp body.

【Contents of Tightening Kit】

• Wedge 1 • Wedge 2 • Tightening Bolt

Model No.	WHZ1001-W	WHZ1601-W	WHZ2501-W	WHZ4001-W
Corresponding Model No.	WHA0320-2□□□-A	WHA0400-2□□□-A	WHA0500-2□□□-A	WHA0630-2□□□-A
Nominal×Pitch of Tightening Bolt	M4×0.7	M4×0.7	M5×0.8	M6×1
Hex. Socket mm	2.5	2.5	3	4
Tightening Torque N·m	2.5	2.5	5.0	8.0

Accessories : Material Swing Lever for Quick Change Lever Option A

Model No. Indication

WHZ 160 0 - A

Size
(Refer to the table.)

Design No.
(Revision Number)

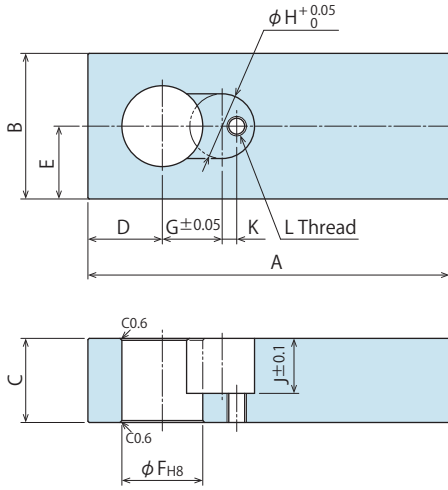

Model No.	WHZ0600-A	WHZ1000-A	WHZ1600-A	WHZ2500-A	WHZ4000-A
Corresponding Model No.	WHD0600-2□-A	WHD1000-2□-A	WHD1600-2□-A	WHD2500-2□-A	WHD4000-2□-A
A	90	90	125	150	170
B	21	25	28	34	45
C	14	16	18	22	26
D	10.5	12.5	14	17	23
E	10.5	12.5	14	17	22.5
F	12 ^{+0.027} ₀	14 ^{+0.027} ₀	16 ^{+0.027} ₀	20 ^{+0.033} ₀	25 ^{+0.033} ₀
G	10.75	12	13	16	18.5
H	10.5	12	12	15	20
J	9.5	11	11	13	17
K	1.25	2	2	2.5	4.5
L	M4×0.7	M4×0.7	M4×0.7	M5×0.8	M6×1

Notes :

1. Material : S50CH Surface Finishing : Alkaline Blackening
2. If necessary, the front end should be additionally machined and finished.
3. The pin hole for stopper and lever phasing should be additionally machined by referring to Quick Change Lever Option A Design Dimensions.
4. Tightening Kit (WHZ□-W) for Quick Change Lever Option A is sold separately.

Accessory : Tightening Kit for Quick Change Lever Option A

Tightening Kit for mounting Quick Change Lever Option A.

Sold separately from clamp body.

[Contents of Tightening Kit]

- Wedge 1 • Wedge 2 • Tightening Bolt

WHZ 160 1 - W

1

2

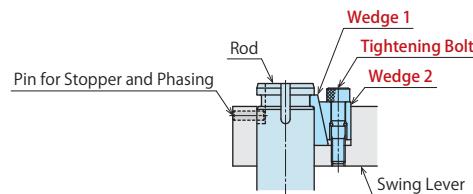
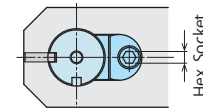

1 Corresponding Model No.

- | | |
|---------------------------|---------------------------|
| 060 : WHD0600-2□-A | 250 : WHD2500-2□-A |
| 100 : WHD1000-2□-A | 400 : WHD4000-2□-A |
| 160 : WHD1600-2□-A | |

2 Design No.

1 : Revision Number

Model No.	WHZ0601-W	WHZ1001-W	WHZ1601-W	WHZ2501-W	WHZ4001-W
Corresponding Model No.	WHD0600-2□-A	WHD1000-2□-A	WHD1600-2□-A	WHD2500-2□-A	WHD4000-2□-A
Nominal×Pitch of Tightening Bolt	M4×0.7	M4×0.7	M4×0.7	M5×0.8	M6×1
Hex. Socket mm	2.5	2.5	2.5	3	4
Tightening Torque N·m	2.5	2.5	2.5	5.0	8.0

High-Power Series

Pneumatic Series

Hydraulic Series

Valve / Coupler Hydraulic Unit

Manual Operation Accessories

Cautions / Others

Pneumatic Hole Clamp

SWA

Pneumatic Swing Clamp

WHA

Double Piston Pneumatic Swing Clamp

WHD

Pneumatic Link Clamp

WCA

Air Flow Control Valve

BZW

Pneumatic Expansion Locating Pin

VWM

VWK

Pneumatic Sensor Pin

WWA

Accessories : Material Swing Lever for Taper Lock Option

Model No. Indication

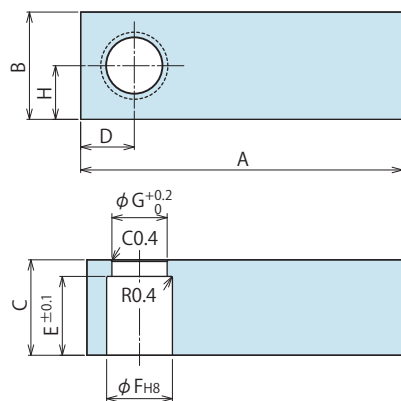
WHZ 160 0 - TSize
(Refer to the table.)Design No.
(Revision Number)

(mm)

Model No.	WHZ0600-T	WHZ1000-T	WHZ1600-T	WHZ2500-T	WHZ4000-T
Corresponding Model No.	WHE0600-2□□□	WHE1000-2□□□	WHE1600-2□□□	WHE2500-2□□□	WHE4000-2□□□
	WHE0600-2□□□-Y□	WHE1000-2□□□-Y□	WHE1600-2□□□-Y□	WHE2500-2□□□-Y□	WHE4000-2□□□-Y□
A	90	90	125	150	170
B	21	25	28	34	45
C	14	16	18	22	26
D	10.5	12.5	14	17	23
E	11	13	15	18	22
F	14 + ^{0.027} ₀	16 + ^{0.027} ₀	18 + ^{0.027} ₀	22 + ^{0.033} ₀	28 + ^{0.033} ₀
G	11	13	15	17	23.5
H	10.5	12.5	14	17	22.5

Notes :

1. Material : S50C Surface Finishing : Alkaline Blackening
2. If necessary, the front end should be additionally machined and finished.
3. When determining the phase, refer to taper lock lever design dimensions for each model for the additional machining.

※1. Refer to Accessory of Quick Change Lever Option A for -A (Quick Change Lever Option A). Refer to Accessory of Quick Change Lever Option F for -F (Quick Change Lever Option F). For -P (Balance Lever Option), it should be designed by customer.

Accessories : Material Swing Lever for Quick Change Lever Option A

Model No. Indication

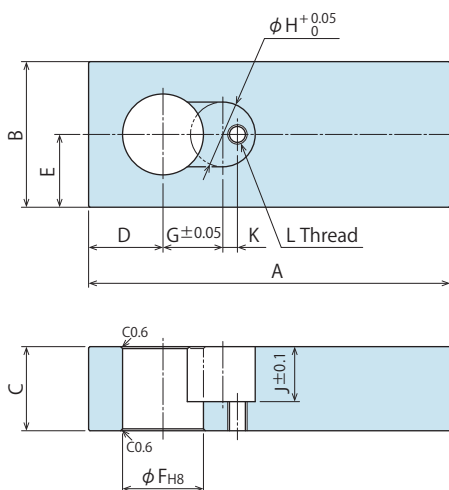
WHZ 160 0 - ASize
(Refer to the table.)Design No.
(Revision Number)

(mm)

Model No.	WHZ0600-A	WHZ1000-A	WHZ1600-A	WHZ2500-A	WHZ4000-A
Corresponding Model No.	WHE0600-2□□□-A	WHE1000-2□□□-A	WHE1600-2□□□-A	WHE2500-2□□□-A	WHE4000-2□□□-A
A	90	90	125	150	170
B	21	25	28	34	45
C	14	16	18	22	26
D	10.5	12.5	14	17	23
E	10.5	12.5	14	17	22.5
F	12 + ^{0.027} ₀	14 + ^{0.027} ₀	16 + ^{0.027} ₀	20 + ^{0.033} ₀	25 + ^{0.033} ₀
G	10.75	12	13	16	18.5
H	10.5	12	12	15	20
J	9.5	11	11	13	17
K	1.25	2	2	2.5	4.5
L	M4×0.7	M4×0.7	M4×0.7	M5×0.8	M6×1

Notes :

1. Material : S50CH Surface Finishing : Alkaline Blackening
2. If necessary, the front end should be additionally machined and finished.
3. The pin hole for stopper and lever phasing should be additionally machined by referring to Quick Change Lever Option A Design Dimensions.
4. Tightening Kit (WHZ□-W) for Quick Change Lever Option A is sold separately.

Accessories : Tightening Kit for Quick Change Lever Option A

Model No. Indication

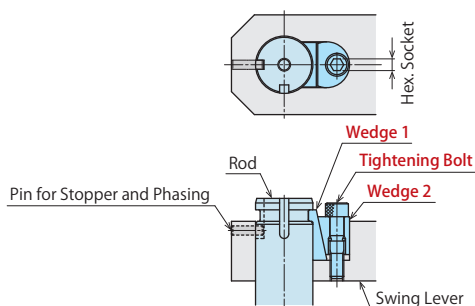
WHZ 160 1 - WSize
(Refer to the table.)Design No.
(Revision Number)

Tightening Kit for mounting Quick Change Lever Option A.
Sold separately from clamp body.

【Contents of Tightening Kit】

• Wedge 1 • Wedge 2 • Tightening Bolt

Model No.	WHZ0601-W	WHZ1001-W	WHZ1601-W	WHZ2501-W	WHZ4001-W
Corresponding Model No.	WHE0600-2□□□-A	WHE1000-2□□□-A	WHE1600-2□□□-A	WHE2500-2□□□-A	WHE4000-2□□□-A
Nominal × Pitch of Tightening Bolt	M4×0.7	M4×0.7	M4×0.7	M5×0.8	M6×1
Hex. Socket mm	2.5	2.5	2.5	3	4
Tightening Torque N·m	2.5	2.5	2.5	5.0	8.0