

● Accessories : Material Link Lever

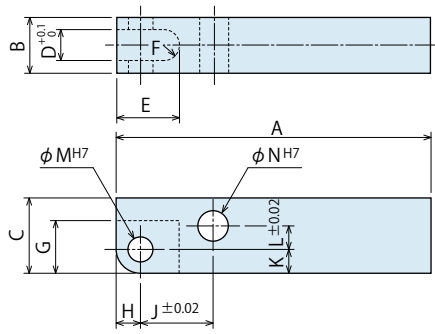

Model No. Indication

LZK 048 0 - L
 Size (Refer to the table.) | Design No. (Revision Number)

Model No.	LZK0360-L	LZK0400-L	LZK0480-L	LZK0550-L	LZK0650-L	LZK0750-L	LZK0900-L	LZK1050-L
Corresponding Model No.	LKA0360	LKA0400	LKA0480	LKA0550	LKA0650	LKA0750	LKA0900	LKA1050
A	65	75	85	90	105	110	160	220
B	10 ⁰ _{-0.2}	12 ⁰ _{-0.3}	12 ⁰ _{-0.3}	16 ⁰ _{-0.3}	19 ⁰ _{-0.3}	22 ⁰ _{-0.3}	25 ⁰ _{-0.3}	32 ⁰ _{-0.4}
C	12.5	14	16	20	25	32	38	45
D	5	6	6	8	10	11	13	16
E	12.5	14.5	16	16.5	21	25.5	30.5	36
F	R2.5	R3	R3	R4	R5	R5.5	R6.5	R8
G	10	12	13	13	17.5	22	26	30.5
H	4.5	5.5	6	6	8	10	11	13
J	14.5	16	18.5	21	24.5	30	36	44
K	4.5	5.5	6	6	8	10	11	13
L	2.5	2.5	3.5	6	7.5	9.5	13	16
M	5 ^{+0.012} ₀	6 ^{+0.012} ₀	6 ^{+0.012} ₀	6 ^{+0.012} ₀	8 ^{+0.015} ₀	10 ^{+0.015} ₀	12 ^{+0.018} ₀	15 ^{+0.018} ₀
N	5 ^{+0.012} ₀	6 ^{+0.012} ₀	6 ^{+0.012} ₀	8 ^{+0.015} ₀	10 ^{+0.015} ₀	12 ^{+0.018} ₀	15 ^{+0.018} ₀	18 ^{+0.018} ₀

Notes :

1. Material S45C
2. If necessary, the front end should be additionally machined.
3. For [6] Option **Blank/H/K**, use the attached pin (equivalent to φADf6, φAEf6, HRC60) as the lever mounting pin.
4. For [6] Option **A**, the lever mounting pin is not included in the clamp.
Please order Tightening Kit for Quick Change Lever Type A (LZK□-W).
5. When using Tightening Kit for Quick Change Lever Type A (LZK□-W), a tapped hole should be additionally machined.
Refer to the link lever design dimensions (P Screw part) for additional machining.

● Accessories : Tightening Kit for Quick Change Lever Type A

Model No. Indication

LZK 040 0 - W
 Size (Refer to the table.) | Design No. (Revision Number)

Tightening Kit for mounting Quick Change Lever Type A.
 Sold separately from clamp body.

[Contents of Tightening Kit]

- Cover (with Bolt)
- Rod Pin
- Lever Pin

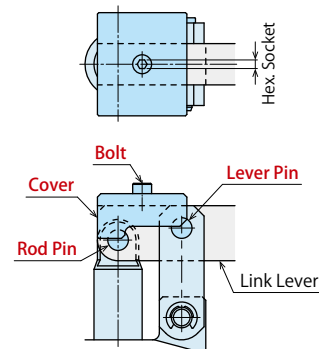

Model No.	LZK0360-W	LZK0400-W	LZK0480-W	LZK0550-W	LZK0650-W	LZK0750-W	LZK0900-W	LZK1050-W
Corresponding Model No.	LKA0360-□-A	LKA0400-□-A	LKA0480-□-A	LKA0550-□-A	LKA0650-□-A	LKA0750-□-A	LKA0900-□-A	LKA1050-□-A
Nominal×Pitch of Bolt	M3×0.5	M3×0.5	M3×0.5	M3×0.5	M4×0.7	M4×0.7	M5×0.8	M5×0.8
Hex. Socket mm	2.5	2.5	2.5	2.5	3	3	4	4
Tightening Torque N·m	1.3	1.3	1.3	1.3	3.2	3.2	6.3	6.3

- High-Power Series
- Pneumatic Series
- Hydraulic Series
- Valve / Coupler Hydraulic Unit
- Manual Operation Accessories
- Cautions / Others
- Hole Clamp
 - SFA
 - SFC
- Swing Clamp
 - LHA
 - LHC
 - LHS
 - LHW
 - LT/LG
 - TLA-2
 - TLB-2
 - TLA-1
- Link Clamp
 - LKA
 - LKC
 - LKW
 - LM/LJ
 - TMA-2
 - TMA-1
- Work Support
 - LD
 - LC
 - TNC
 - TC
- Air Sensing Lift Cylinder
 - LLW
- Compact Cylinder
 - LL
 - LLR
 - LLU
 - DP
 - DR
 - DS
 - DT
- Block Cylinder
 - DBA
 - DBC
- Centering Vise
 - FVA
 - FVD
 - FVC
- Control Valve
 - BZL
 - BZT
 - BZX/JZG
- Pallet Clamp
 - VS
 - VT
- Expansion Locating Pin
 - VFL
 - VFM
 - VFJ
 - VFK
- Pull Stud Clamp
 - FP
 - FQ
- Customized Spring Cylinder
 - DWA/DWB

Sales Offices

Sales Offices across the World

Japan	TEL. +81-78-991-5162	FAX. +81-78-991-8787
Overseas Sales	KOSMEK LTD. 1-5, 2-chome, Murotani, Nishi-ku, Kobe-city, Hyogo, Japan 651-2241 〒651-2241 兵庫県神戸市西区室谷2丁目1番5号	
USA	TEL. +1-630-620-7650	FAX. +1-630-620-9015
KOSMEK (USA) LTD.	650 Springer Drive, Lombard, IL 60148 USA	
Mexico	TEL. +52-442-161-2347	
KOSMEK USA Mexico Office	Blvd Jurica la Campana 1040, B Colonia Punta Juriquilla Queretaro, QRO 76230 Mexico	
EUROPE	TEL. +43-463-287587	FAX. +43-463-287587-20
KOSMEK EUROPE GmbH	Schleppeplatz 2 9020 Klagenfurt am Wörthersee Austria	
China	TEL.+86-21-54253000	FAX.+86-21-54253709
KOSMEK (CHINA) LTD. 考世美(上海)贸易有限公司	Room601, RIVERSIDE PYRAMID No.55, Lane21, Pusan Rd, Pudong Shanghai 200125, China 中国上海市浦东新区浦三路21弄55号银亿滨江中心601室200125	
India	TEL.+91-9880561695	
KOSMEK LTD. - INDIA	F 203, Level-2, First Floor, Prestige Center Point, Cunningham Road, Bangalore -560052 India	
Thailand	TEL. +66-2-300-5132	FAX. +66-2-300-5133
Thailand Representative Office	67 Soi 58, RAMA 9 Rd., Suanluang, Suanluang, Bangkok 10250, Thailand	
Taiwan (Taiwan Exclusive Distributor)	TEL. +886-2-82261860	FAX. +886-2-82261890
Full Life Trading Co., Ltd. 盈生貿易有限公司	16F-4, No.2, Jian Ba Rd., Zhonghe District, New Taipei City Taiwan 23511 台湾新北市中和區建八路2號 16F-4 (遠東世紀廣場)	
Philippines (Philippines Exclusive Distributor)	TEL.+63-2-310-7286	FAX. +63-2-310-7286
G.E.T. Inc, Phil.	Victoria Wave Special Economic Zone Mt. Apo Building, Brgy. 186, North Caloocan City, Metro Manila, Philippines 1427	
Indonesia (Indonesia Exclusive Distributor)	TEL. +62-21-5818632	FAX. +62-21-5814857
P.T PANDU HYDRO PNEUMATICS	Ruko Green Garden Blok Z-II No.51 Rt.005 Rw.008 Kedoya Utara-Kebon Jeruk Jakarta Barat 11520 Indonesia	

Sales Offices in Japan

Head Office	TEL.078-991-5115	FAX.078-991-8787
Osaka Sales Office	〒651-2241 兵庫県神戸市西区室谷2丁目1番5号	
Overseas Sales		
Tokyo Sales Office	TEL.048-652-8839	FAX.048-652-8828
	〒331-0815 埼玉県さいたま市北區大成町4丁目81番地	
Nagoya Sales Office	TEL.0566-74-8778	FAX.0566-74-8808
	〒446-0076 愛知県安城市美園町2丁目10番地1	
Fukuoka Sales Office	TEL.092-433-0424	FAX.092-433-0426
	〒812-0006 福岡県福岡市博多区上牟田1丁目8-10-101	

Global Network

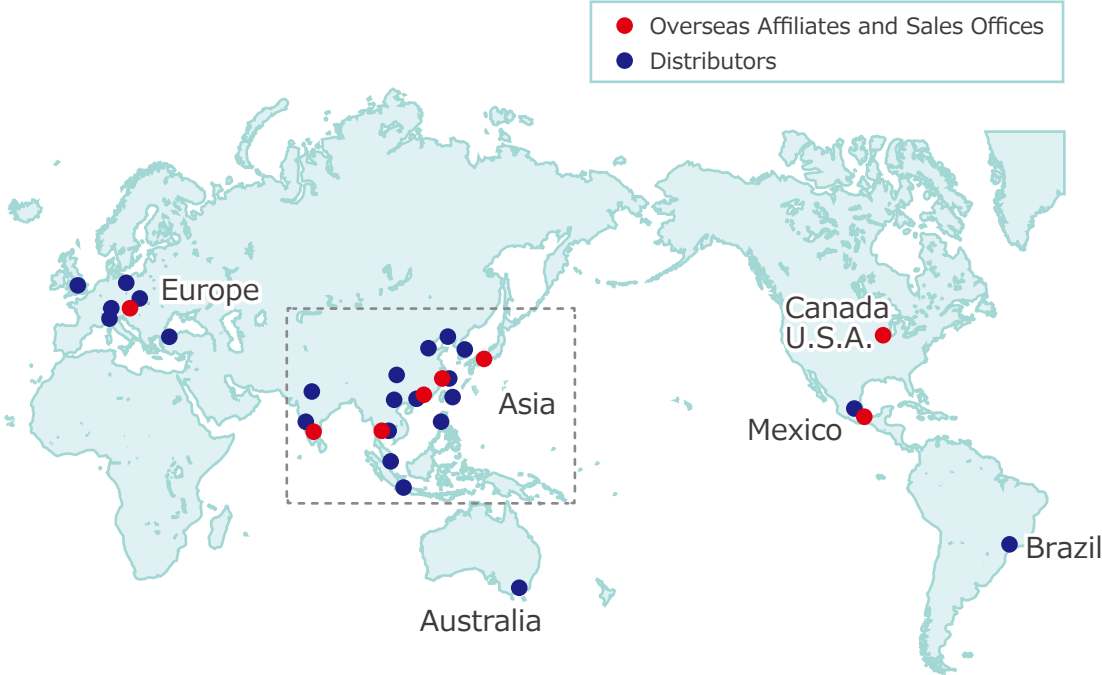

Asia Detailed Map

