

● Accessories : Material Link Lever

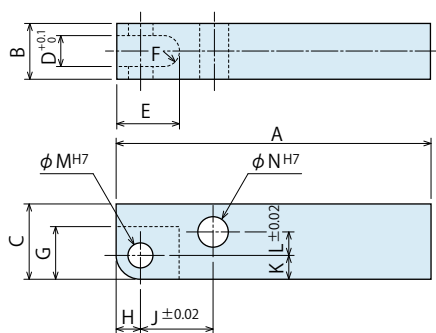

Model No. Indication

LZK 048 0 - L
 Size (Refer to the table.) | Design No. (Revision Number)

(mm)

Model No.	LZK0360-L	LZK0400-L	LZK0480-L	LZK0550-L	LZK0650-L	LZK0750-L	LZK0900-L	LZK1050-L
Corresponding Model No.	LKA0360	LKA0400	LKA0480	LKA0550	LKA0650	LKA0750	LKA0900	LKA1050
A	65	75	85	90	105	110	160	220
B	10 ⁰ _{-0.2}	12 ⁰ _{-0.3}	12 ⁰ _{-0.3}	16 ⁰ _{-0.3}	19 ⁰ _{-0.3}	22 ⁰ _{-0.3}	25 ⁰ _{-0.3}	32 ⁰ _{-0.4}
C	12.5	14	16	20	25	32	38	45
D	5	6	6	8	10	11	13	16
E	12.5	14.5	16	16.5	21	25.5	30.5	36
F	R2.5	R3	R3	R4	R5	R5.5	R6.5	R8
G	10	12	13	13	17.5	22	26	30.5
H	4.5	5.5	6	6	8	10	11	13
J	14.5	16	18.5	21	24.5	30	36	44
K	4.5	5.5	6	6	8	10	11	13
L	2.5	2.5	3.5	6	7.5	9.5	13	16
M	5 ^{+0.012} ₀	6 ^{+0.012} ₀	6 ^{+0.012} ₀	6 ^{+0.012} ₀	8 ^{+0.015} ₀	10 ^{+0.015} ₀	12 ^{+0.018} ₀	15 ^{+0.018} ₀
N	5 ^{+0.012} ₀	6 ^{+0.012} ₀	6 ^{+0.012} ₀	8 ^{+0.015} ₀	10 ^{+0.015} ₀	12 ^{+0.018} ₀	15 ^{+0.018} ₀	18 ^{+0.018} ₀

Notes :

1. Material S45C
2. If necessary, the front end should be additionally machined.
3. For [6] Option **Blank/H/K**, use the attached pin (equivalent to φADf6, φAEf6, HRC60) as the lever mounting pin.
4. For [6] Option **A**, the lever mounting pin is not included in the clamp.
Please order Tightening Kit for Quick Change Lever Type A (LZK□-W).
5. When using Tightening Kit for Quick Change Lever Type A (LZK□-W), a tapped hole should be additionally machined.
Refer to the link lever design dimensions (P Screw part) for additional machining.

● Accessories : Tightening Kit for Quick Change Lever Type A

Model No. Indication

LZK 040 0 - W
 Size (Refer to the table.) | Design No. (Revision Number)

Tightening Kit for mounting Quick Change Lever Type A.
 Sold separately from clamp body.

【Contents of Tightening Kit】

- Cover (with Bolt)
- Rod Pin
- Lever Pin

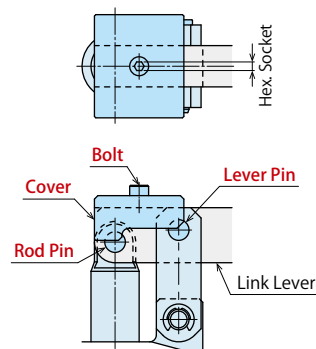

Model No.	LZK0360-W	LZK0400-W	LZK0480-W	LZK0550-W	LZK0650-W	LZK0750-W	LZK0900-W	LZK1050-W
Corresponding Model No.	LKA0360-□-A	LKA0400-□-A	LKA0480-□-A	LKA0550-□-A	LKA0650-□-A	LKA0750-□-A	LKA0900-□-A	LKA1050-□-A
Nominal×Pitch of Bolt	M3×0.5	M3×0.5	M3×0.5	M3×0.5	M4×0.7	M4×0.7	M5×0.8	M5×0.8
Hex. Socket mm	2.5	2.5	2.5	2.5	3	3	4	4
Tightening Torque N·m	1.3	1.3	1.3	1.3	3.2	3.2	6.3	6.3

- High-Power Series
- Pneumatic Series
- Hydraulic Series
- Valve / Coupler Hydraulic Unit
- Manual Operation Accessories
- Cautions / Others
- Hole Clamp
 - SFA
 - SFC
- Swing Clamp
 - LHA
 - LHC
 - LHS
 - LHW
 - LT/LG
 - TLA-2
 - TLB-2
 - TLA-1
- Link Clamp
 - LKA
 - LKC
 - LKW
 - LM/LJ
 - TMA-2
 - TMA-1
- Work Support
 - LD
 - LC
 - TNC
 - TC
- Air Sensing Lift Cylinder
 - LLW
- Compact Cylinder
 - LL
 - LLR
 - LLU
 - DP
 - DR
 - DS
 - DT
- Block Cylinder
 - DBA
 - DBC
- Centering Vise
 - FVA
 - FVD
 - FVC
- Control Valve
 - BZL
 - BZT
 - BZX/JZG
- Pallet Clamp
 - VS
 - VT
- Expansion Locating Pin
 - VFL
 - VFM
 - VFJ
 - VFK
- Pull Stud Clamp
 - FP
 - FQ
- Customized Spring Cylinder
 - DWA/DWB

Accessory : Material Link Lever

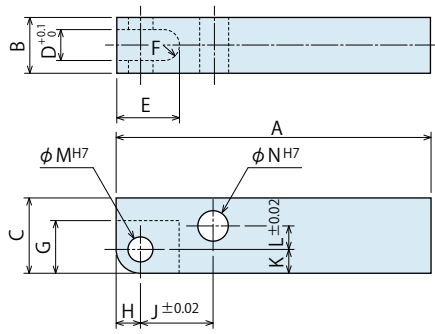

Model No. Indication

LZK 048 0 - L

Size (Refer to the table)

Design No. (Revision Number)

(mm)

Model No.	LZK0400-L	LZK0480-L	LZK0550-L	LZK0650-L
Corresponding Model No.	LKC0400	LKC0480	LKC0550	LKC0650
A	75	85	90	105
B	12 _{-0.3} ⁰	12 _{-0.3} ⁰	16 _{-0.3} ⁰	19 _{-0.3} ⁰
C	14	16	20	25
D	6	6	8	10
E	14.5	16	16.5	21
F	R3	R3	R4	R5
G	12	13	13	17.5
H	5.5	6	6	8
J	16	18.5	21	24.5
K	5.5	6	6	8
L	2.5	3.5	6	7.5
M	6 ₀ ^{+0.012}	6 ₀ ^{+0.012}	6 ₀ ^{+0.012}	8 ₀ ^{+0.015}
N	6 ₀ ^{+0.012}	6 ₀ ^{+0.012}	8 ₀ ^{+0.015}	10 ₀ ^{+0.015}

- Notes :
1. Material S45C
 2. If necessary, the front end should be additionally machined.
 3. Please use the attached pin (equivalent to ϕ ADf6, ϕ AEf6, HRC60) as the mounting pin for lever.

High-Power Series

Pneumatic Series

Hydraulic Series

Valve / Coupler Hydraulic Unit

Manual Operation Accessories

Cautions / Others

Hole Clamp

SFA
SFC

Swing Clamp

LHA
LHC
LHS
LHW
LT/LG
TLA-2
TLB-2
TLA-1

Link Clamp

LKA
LKC
LKW
LM/LJ
TMA-2
TMA-1

Work Support

LD
LC
TNC
TC

Air Sensing Lift Cylinder

LLW

Compact Cylinder

LL
LLR
LLU
DP
DR
DS
DT

Block Cylinder

DBA
DBC

Centering Vise

FVA
FVD
FVC

Control Valve

BZL
BZT
BZX/JZG

Pallet Clamp

VS
VT

Expansion Locating Pin

VFL
VFM
VFJ
VFK

Pull Stud Clamp

FP
FQ

Customized Spring Cylinder

DWA/DWB

Accessories : Material Link Lever

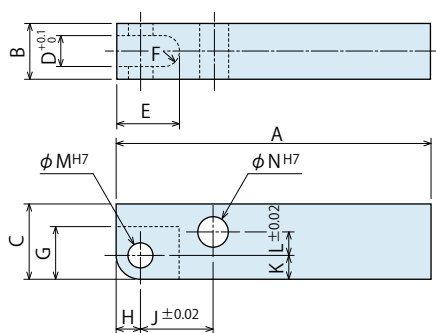

Model No. Indication

LZK 040 0 - L2

Size
(Refer to the table.)

Design No.
(Revision Number)

(mm)

Model No.	LZK0300-L2	LZK0360-L2	LZK0400-L2	LZK0480-L2	LZK0550-L2
Corresponding Model No.	LKE0300	LKE0360	LKE0400	LKE0480	LKE0550
A	50	65	75	85	90
B	$9 \begin{smallmatrix} 0 \\ -0.1 \end{smallmatrix}$	$10 \begin{smallmatrix} 0 \\ -0.2 \end{smallmatrix}$	$12 \begin{smallmatrix} 0 \\ -0.3 \end{smallmatrix}$	$12 \begin{smallmatrix} 0 \\ -0.3 \end{smallmatrix}$	$16 \begin{smallmatrix} 0 \\ -0.3 \end{smallmatrix}$
C	11	12.5	15.5	18	21.5
D	4.5	5	6	6	8
E	8.5	12.5	14.5	16	17
F	R2.25	R2.5	R3	R3	R4
G	8.5	10	12	13	13.5
H	4	4.5	5.5	6	6
J	12.5	14.5	16	18.5	21
K	4	4.5	5.5	6	6
L	2.5	2.5	2.5	3.5	6
M	$4 \begin{smallmatrix} +0.012 \\ 0 \end{smallmatrix}$	$5 \begin{smallmatrix} +0.012 \\ 0 \end{smallmatrix}$	$6 \begin{smallmatrix} +0.012 \\ 0 \end{smallmatrix}$	$6 \begin{smallmatrix} +0.012 \\ 0 \end{smallmatrix}$	$7 \begin{smallmatrix} +0.015 \\ 0 \end{smallmatrix}$
N	$4 \begin{smallmatrix} +0.012 \\ 0 \end{smallmatrix}$	$5 \begin{smallmatrix} +0.012 \\ 0 \end{smallmatrix}$	$6 \begin{smallmatrix} +0.012 \\ 0 \end{smallmatrix}$	$7 \begin{smallmatrix} +0.015 \\ 0 \end{smallmatrix}$	$8 \begin{smallmatrix} +0.015 \\ 0 \end{smallmatrix}$

Notes: 1. Material : S50CH

2. If necessary, the front end should be additionally machined.

3. Please use the attached pin (equivalent to ϕAD f6, ϕAE f6, HRC60) as the mounting pin for lever.
(Please refer to each external dimension of LKE for the dimensions ϕAD and ϕAE .)

High-Power Series

Pneumatic Series

Hydraulic Series

Valve / Coupler
Hydraulic Unit

Manual Operation
Accessories

Cautions / Others

High-Power Hydraulic
Swing Clamp

LHE

High-Power Hydraulic
Link Clamp

LKE

High-Power Pneumatic
Hole Clamp

SWE

High-Power Pneumatic
Swing Clamp

WHE

High-Power Pneumatic
Link Clamp

WCE

High-Power Pneumatic
Work Support

WNC

Rodless Hollow
Pneumatic Work Support

WNA

High-Power Pneumatic
Pallet Clamp

WVS

Accessory : Material Link Lever

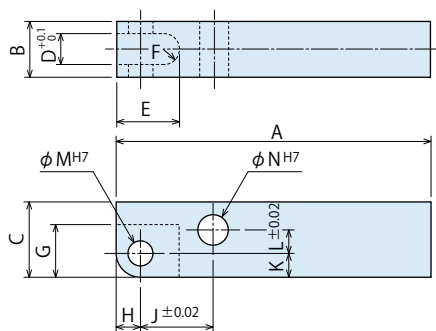

Model No. Indication

LZK 048 0 - L

Size
(Refer to the table)

Design No.
(Revision Number)

(mm)

Model No.	LZK0400-L	LZK0480-L	LZK0550-L	LZK0650-L	LZK0750-L
Corresponding Model No.	LKW0401	LKW0481	LKW0551	LKW0651	LKW0751
A	75	85	90	105	110
B	12 ⁰ _{-0.3}	12 ⁰ _{-0.3}	16 ⁰ _{-0.3}	19 ⁰ _{-0.3}	22 ⁰ _{-0.3}
C	14	16	20	25	32
D	6	6	8	10	11
E	14.5	16	16.5	21	25.5
F	R3	R3	R4	R5	R5.5
G	12	13	13	17.5	22
H	5.5	6	6	8	10
J	16	18.5	21	24.5	30
K	5.5	6	6	8	10
L	2.5	3.5	6	7.5	9.5
M	6 ^{+0.012} ₀	6 ^{+0.012} ₀	6 ^{+0.012} ₀	8 ^{+0.015} ₀	10 ^{+0.015} ₀
N	6 ^{+0.012} ₀	6 ^{+0.012} ₀	8 ^{+0.015} ₀	10 ^{+0.015} ₀	12 ^{+0.018} ₀

Notes : 1. Material S45C

- If necessary, the front end should be additionally machined.
- Please use the attached pin (equivalent to ϕ ADf6, ϕ AEf6, HRC60) as the mounting pin for lever.

High-Power
Series

Pneumatic Series

Hydraulic Series

Valve / Coupler
Hydraulic Unit

Manual Operation
Accessories

Cautions / Others

Hole Clamp

SFA
SFC

Swing Clamp

LHA
LHC
LHS
LHW
LT/LG
TLA-2
TLB-2
TLA-1

Link Clamp

LKA
LKC

LKW

LM/LJ
TMA-2
TMA-1

Work Support

LD
LC
TNC
TC

Air Sensing
Lift Cylinder

LLW

Compact Cylinder

LL
LLR
LLU
DP
DR
DS
DT

Block Cylinder

DBA
DBC

Centering Vise

FVA
FVD
FVC

Control Valve

BZL
BZT
BZX/JZG

Pallet Clamp

VS
VT

Expansion Locating Pin

VFL
VFM
VFJ
VFK

Pull Stud Clamp

FP
FQ

Customized
Spring Cylinder

DWA/DWB